



Project	
Notes	
Type	Date
Cat. No.	

CHF™ Series

CHF 52" Ceiling Fan



DESCRIPTION

The CHF series is a family of ceiling fans featuring a simple 5 blade design. The clean lines and traditional design of this AC Motor LED fan makes an elegant addition to your home décor. The reversible feature makes this fan perfect to use during every season.

CHF Series
52' Sweep



Limited Warranty 3 years

Specification Features

Special Order

Construction

Steel Housing, Plywood Blades and Frosted Glass Light Diffuser provides uniform appearance without pixelation.

Qualifications

All ceiling fans are built to UL 507 standards, and bear appropriate ETL labels. Dry location labeling is standard.

Motor

3-Speed AC Motor with 80" Lead Wire. Includes (1) 5" Downrod.

Warranty

Motor: Limited Lifetime Warranty. Non-Electrical 1 Year Limited Warranty. See complete warranty for terms and exclusions. (Labor not included).

Blades

52" Sweep, 5 Blade Configuration Blade
Pitch Angle: 12.5°
Color: Dark Walnut

Electrical

Operates at 120V 60HZ. Optional Remote Control (Sold Separately). Optional Wall Control (Sold Separately).

Ordering Information

Example: CHF-52-5-120-BN-PC

HEF	52	5	120	BN	RW	PC
Series	Size	Fan Blade	Voltage	Finish	Blade Color	Options
CHF Ceiling Fan	52- 52" Sweep	5-5 Blades	120- 120V	BN- Brushed Nickel WH- White BL- Black ORB- Oil Rubbed Bronze	DW- Dark Walnut WH- White	PC- Pull Chain

Specifications and Dimensions subject to change without notice.

Fan Performance Summary

Fan Diameter	52"
Motor Lead Lengths	80"
Motor Size	AC 153mm x 18mm
Electricity Use (H/M/L)	64W/26.8W/10.6W
AMPS (H/M/L)	0.52/0.35/0.22

Fan Performance Data

RPM (H/M/L)	181/119/71
Airflow Efficiency (CFM/W)	88
Airflow (CFM)	High Speed: 5,481
Average Airflow CFMav	3,328

Product Dimensions

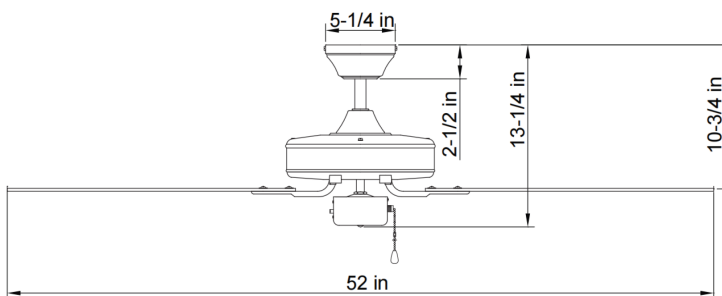

NOTES:

- ¹ Made to order items. Minimum 90 day lead time. Minimum 500 order quantity.
- ⁴ Typical color consistency. May vary or be changed.
- ⁵ L70 hours calculated based on LED package manufacturer LM80 report and ISTMT report of LED in luminaire. Stated values are for select catalog numbers. Contact manufacturer for detailed information
- ⁶ Actual performance may differ as a result of end-user environment and application. All values are design or typical values, measured under laboratory conditions at 25 °C.



Specifications and Dimensions subject to change without notice.